

Instruction Manual

SUNJE
Electrostatic



SIC-150

(Eng)

It is recommended that only persons who have sufficient knowledge and experience such as system designers and responsible persons deal with this product after carefully reading the product manual.

1 The matters of safety

WARNING

- * If the equipment is used in a manner not specified by the manufacturer, the protection provided by the equipment may be impaired.
- * Do not let the water touch the product. It may cause electric shock or fire due to malfunction.
- * When you check or maintain the product, make it sure you turn off the power. It may cause electric shock or fire due to malfunction.
- * Do not use the product at the place where dangerous material such as inflammable or ignitable material exists. This product is not the product of anti-explosive type.
- * This device is made only for industrial uses. You need to ground the device beforehand. Otherwise, there are in case of malfunction, electric shock, or fire damage.
- * This device uses compressed air(CDA). Do not use the device if the CDA cannot be allowed to use. In some cases, the product malfunction or danger of accident might happen.
- * Secure working space when you install the product. If working space is not secured, the checking or maintenance of the product is made impossible leading to failure of the product.

CAUTION

- * Do not contact the terminal with power applied. There is a possibility of electric shock or malfunction.
- * Connect wires referring to the product manual. Wrong connection can cause failures.
- * Do not use the product for the purpose outside of the range of the product use. If the product is used for the purpose outside of the range of the use, it can result in the trouble or the shortened service life. Or an unexpected problem may occur.
- * The ionizer generates ozone(below 0.05ppm). If you sense the smell of ozone when you use more than two units, ventilate the air.
- * Please periodically clean the filter. Otherwise, Degraded in product performance and will cause a malfunction.

2 Check the package contents

Product compositions

The package includes the following products composition.

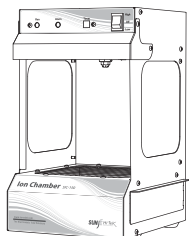

Ion Chamber
SIC-150
1ea



Power Cable
SPC-MT-1-001
AC 100V, 50/60Hz, 1.8m / 1ea
or
Ground Cable
SGC-MT-2-001
1m / Ø4-Ø4[mm] / 1ea
or
Power Cable
SPC-MT-2-001
AC 220V, 50/60Hz, 1.8m / 1ea

3 Nomenclatures of parts

Front

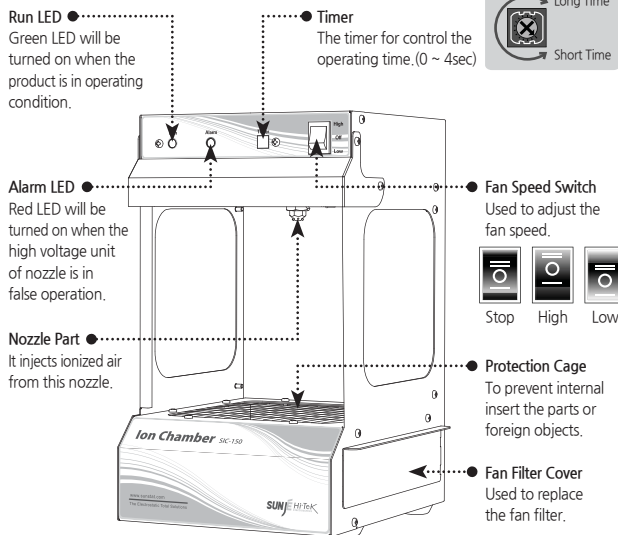

Rear

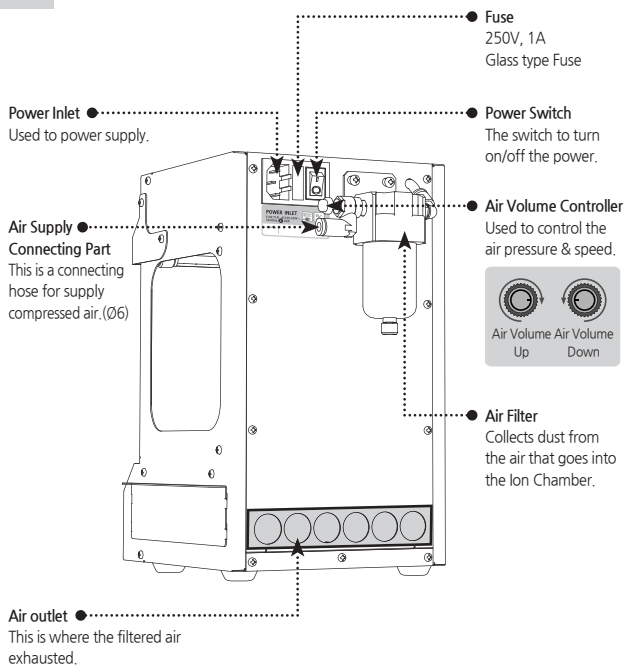

4 Installation and Use

How to install

CAUTION	<ul style="list-style-type: none"> * Please install this product horizontally where the installing place is flattened. * A connecting fitting is Ø6 and accepted air pressure is 1~5MPa.
----------------	--

- Installation Site**
Select a location that is suitable for work and near to an air source and 100~240V AC supply.
- Air**
Place your compressed air hose into the main body's air inlet.
Allowable air pressure is 0.1~0.5MPa.
※ Using compressed air is mandatory for smooth operation of Ion Chamber.
Please be sure to use the compressed air.
- Checks Before Use**
Before use, check the SIC-150, hose and power for trouble.
Make sure there is no damage, loose screws, disconnected hose, loose connectors, etc.

How to use

- SIC-150 is really simple and easy to use.
If you turn the power on, controls all operations within the range of sensor.
- If the main power is on, please set the fan speed of Ion Chamber at level 1 or 2.
 - Corresponds to your environment, use the timer switch to set time.
After the sensor is operated, it additionally can control the time(0~4 seconds).
If you turn right, you'll have more time. If you turn left, you'll have less time.

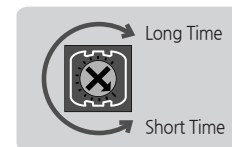

- The strength of the air can be corresponded to your environment and the switch is located at the back of the Ion Chamber.

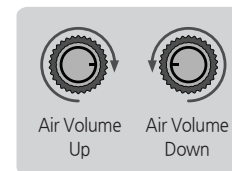

5 Maintenance

Maintenance is an essential item for maintaining its capacity. Please conduct a routine maintenance according to the below description.

CAUTION

- * Please turn off the SIC-150 before the maintenance.
- * If the filter gets polluted, then the performance of SIC-150 will decrease. Therefore, the filter is recommended to be cleaned regularly. (At least once a month)

Fan Filter Separating

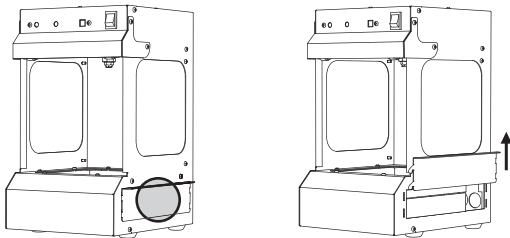

a. Lift the side cover on the right side of the main body.

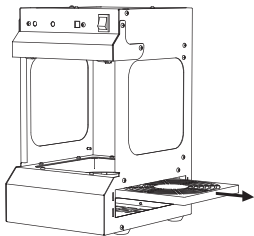

b. Separate the fan filter from the main body.
c. Clean or replace the fan filter corresponds to level of pollution.

Fan Filter Cleaning

- Wash the fan filter in the running water.
- Completely dry the fan filter and insert it into the fan filter cover.
- In case the fan filter is severely damaged, replace it.

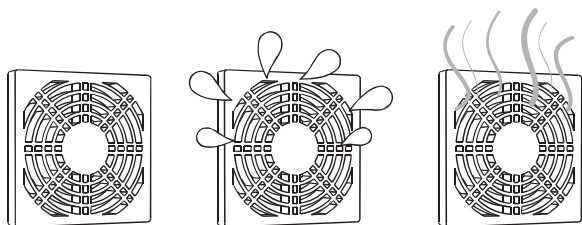

6 Dimensions

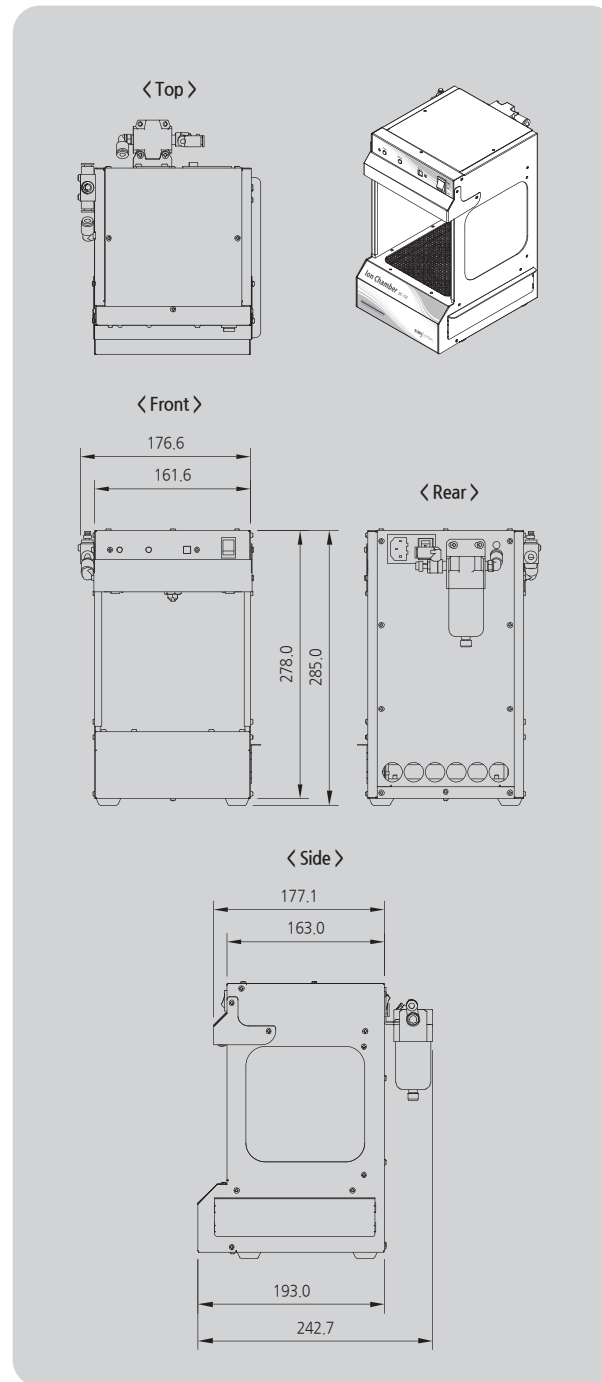

7 Specification

Parameter	Description / Value	Remarks
Input Power	AC 100 ~ 240V, 50/60Hz	
Power Consumption	20W	
Current Consumption	90mA	AC 220V
Ion-Generation Method	High Frequency AC	Piezo
Ion Balance	Within ±20V	
Air Purge Supply Pressure	0.1 ~ 0.5MPa	CDA(Clean Dry Air), N ₂
Operation Circumstance	0℃ ~ +50℃(32 F ~ 122 F), 35% ~ 85% RH	
Main Body Material	SUS 304	
Electrode Material	Tungsten / Titanium	
Weight	3.3kg	
Sensor	Photoelectric Sensor	
Air Flow	2.499m ³ /min	Maximum
Alarm Function	H/V Abnormal	
Warranty	1 year	
Photoelectric Sensor(HP100-A1)		
Detection System	Diffuse-scan	
Power Supply	10 to 30Vdc (ripple 10% max.)	
Current Consumption	Max. 16mA	
Scanning Distance	1m	
Differential Travel	Max. 20% (at rated scanning distance)	
Operation Mode	Light-ON / Dark ON selectable by switch	
Response Time	500ms max. for both operation and recovery	
Emitter	Infrared LED	
Ambient Light Immunity	Incandescent Lamp : Max. 10,000 lux Sunlight : Max. 40,000 lux	

※ The appearance and specification of the product may be changed without prior notice for the improvement of the product.

SUNJE Electrostatics

www.sunstat.com

Head Office & Factory (Busan)

8, Cheonggwang-gil, Ilgwang-Myeon, Gijang-Gun, Busan, Korea
T) +82-51-720-7500 F) +82-51-720-7501

Sunje Japan Co., Ltd.

3-11-16-321 Higashimikuni, Yodogawa-ku, Osaka, Japan
T) +81-6-4866-5202 F) +81-6-6399-9290

Central Sales Office (Hwaseong)

3F, Ilshin B/D, 4, Namnyeoul 2-gil, Hwaseong-si, Gyeonggi-do, Korea
T) +82-31-203-9034 F) +82-31-202-9034

Sunje (SHANGHAI) Trading Co., Ltd.

Room 312, Jiurun Business Building 3rd Floor, No. 298, Yindu Road, Xuhui District, Shanghai, China 200000
T) +86-21-5433-9761 F) +86-21-5433-9762

Southern Sales Office (Chilgok)

35-2, Seojungni 3-gil, Seokjeok-eup, Chilgok-gun, Gyeongsangbuk-do, Korea
T) +82-54-476-9033 F) +82-54-476-9034

Sunje Technology Co., Ltd.

2F, No.6, Lane.102, Sinhe Rd, Sinfong Township, Hsinchu County, Taiwan 30472
T) +886-3-568-7891 F) +886-3-568-7950

Customer Center +82-70-7714-9033

Sales Contact +82-31-203-9034