

Instruction Manual

SUNJE
Electrostatic



SBP-07A2

Eng

It is recommended that only persons who have sufficient knowledge and experience such as system designers and responsible persons deal with this product after carefully reading the product manual.

1 The matters of safety

WARNING

- * If the equipment is used in a manner not specified by the manufacturer, the protection provided by the equipment may be impaired.
- * Do not let the water touch the product. It may cause electric shock or fire due to malfunction.
- * When you check or maintain the product, make it sure you turn off the power. It may cause electric shock or fire due to malfunction.
- * The item should be fixed to the target tightly. Electric discharging or breakage might happen.
- * Do not use the product at the place where dangerous material such as inflammable or ignitable material exists. This product is not the product of anti-explosive type.
- * This device is made only for industrial uses. You need to ground the device beforehand. Otherwise, there are in case of malfunction, electric shock, or fire damage.

CAUTION

- * Do not disconnect the controller cable with power applied. There is a possibility of electric shock or malfunction.
- * Connect wires referring to the product manual. Wrong connection can cause failures.
- * For your proper cable connection, take a look at the manual "Installation & Connection" for references. Any disordered connection is detected, the malfunction might arise.
- * All cables should be connected all the time. Please careful of cable disconnections. If power or communication cables got damaged, replace them immediately. Malfunction and fire danger may happen.
- * Do not install the device where the vibration can be detected. Any minor impact or vibration on the device, the malfunction or danger of accident might happen.
- * Do not use the item off the range of usage(Electrostatic elimination). Malfunction or danger of accident may occur.

2 Check the package contents

Product compositions

The package includes the following products composition.



Power Controller
SBP-07A2
1ea



Power Cable
SPC-MT-1-001
AC 100V, 50/60Hz, 1.8m / 1ea
or
Power Cable
SPC-MT-2-001
AC 220V, 50/60Hz, 1.8m / 1ea



Ground Cable
SGC-MT-2-001
1m /Ø4-Ø4[mm] / 1ea



Signal Cable
SUC-MT-2-001
10m

3 Nomenclatures of parts

SBP-07A2

Top

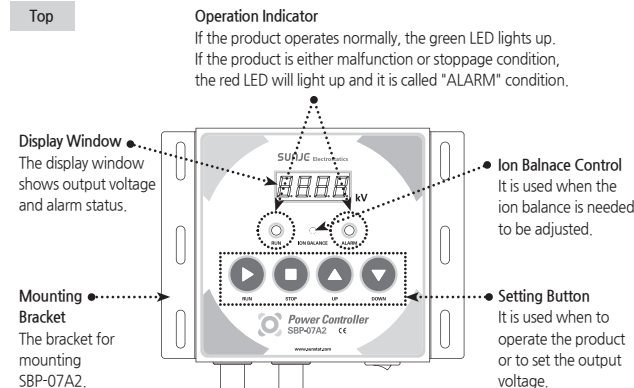

Rear

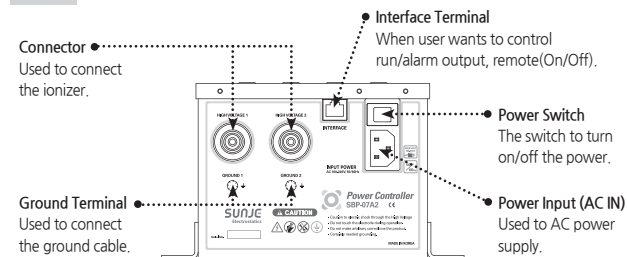

4 Installation and connection

WARNING

- * During installation, please try to avoid the area where the product might get (electrical) stress. There might be chances for cable breakage, electric shock, or fire explosion.
- * Please be sure to use a ground cable for safety purposes and we suggest you to use ground resistance smaller than 100Ω.

How to connect

Please assemble the product through a reference image in below.

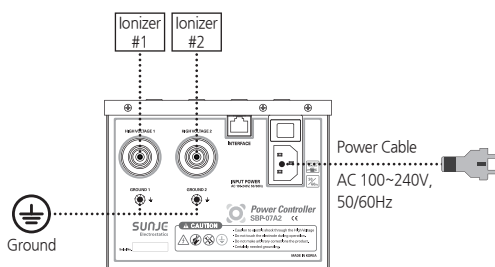

How to connect interface (Signal Cable)

For your information, please consider the below specification chart for "Single Cable".



| No. | Color | Function | Picture | Remarks | |
|-----|----------------|-----------------------|-------------------------|-----------------------------|--|
| 1 | Brown | Remote COM. | | No. 1 / 2 / 3 CLOSED = STOP | |
| 2 | White & Brown | Remote Run | | | |
| 3 | Orange | Remote Stop | | | |
| 4 | White & Orange | Run/Stop(Alarm) State | Run # Closed=25Ω(max) | Stop(Alarm) | Max load : 350V 0.12A (Indicate the peak AC and DC values) |
| 5 | Green | | No.4 Close No.5 Open | No.4 Open No.5 Close | |
| 6 | White & Green | Not Used | | | |
| 7 | Blue | Not Used | | | |
| 8 | White & Blue | Not Used | | | |

Connectable products

The SBP-07A2 (i.e. Power Controller) can be connected to the (multiple) products as below.

| Ion Balance | Type | Model | Construction | Standard Operating Voltage |
|----------------|---------|--------|------------------|----------------------------|
| Adjustable | Ion Bar | SSB1 | Direct Coupled | 4kVac |
| | | SIB1 | | 4.5kVac |
| | | SIB2 | | 4.5kVac |
| Non-Adjustable | Ion Bar | SSB | Capacity Coupled | 7.5kVac |
| | | SKB | | |
| | | SIB-ex | | |
| | | SIBM | | |

CAUTION

- * Try not to assemble with the product that is not properly specified to install. It will be causes of malfunction or operation disorder.
- * Please contact us if you want to use every different model (only with models in the table) in the connection. Connecting the product based on your own discretion, it can cause product failure and malfunction.

Ion balance (Offset) : DC -150V ~+550V

The ion balance is possibly controllable via changing the output voltage offset. Refer to the image below and set the ion balance as you want.

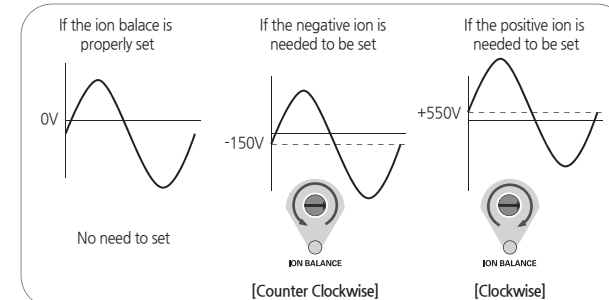
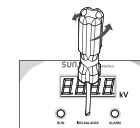

CAUTION

- * The ion balance function is only available with "Direct coupled model".
- * Please set the offset voltage with suggested ion balance voltage standard.

5 How to set

▶ Run & Stop

Press the run or stop button to operate or stop the product.



RUN

- If the product operates normally, the green LED lights up.



STOP

- If you press the stop button, then the red LED will turn off.



RUN

- If you press the run button, the green LED will light up.

CAUTION * Please make sure whether the ionizer is properly connected before operating the devices. (Refer to "Installation and Connection")

▶ How to change output voltage

Any output voltage change is required, please see the following procedure.



- If you press up or down button for 2 seconds, FND will blink and you will be entered to setting mode.



→ Flickering

- Please adjust your expected voltage level by pressing up or down button. (scale of 0.1kV will be changed by pressing either up or down button)



→ Flickering

- After adjusting the voltage, if you press run button for 2 seconds, the set value will be applied.



CAUTION * Try to stay in the standard voltage level, don't try to set voltage level exceeds its standard level. Otherwise, it will cause product malfunction or operation disorder.
* For standard output voltage of product, please see the p.3 "Connectable products" as your reference.

▶ Alarm

It indicates an abnormal condition of the product.



- When alarm appeared, please follow these steps :
1) Power off the device
2) Removing the cause of the alarm
3) Repower on

Power Switch (On▶Off▶On)



* Possible Alarm initiation conditions

- A-1 : If more than 5mA of AC output current
- A-2 : If more than 125% of AC output voltage
- A-3 : If less than 75% of AC output voltage
- A-4 : If output short-circuit occurs.

CAUTION * Alarm is appeared by ionizer's abnormal discharge and state. When alarm appear, please repower on after sufficient check and removing the causes of the alarm. Unless solve a matter of substance, it can be appeared again.

6 Problem solving

▶ Checklist before called

| Symptom | Confirmation Matter | Matters of Management |
|--|--|---|
| The product does not work. | Is your power cable still plugged in? | Please re-plug the power cable and then turn the device on again. |
| | Was the proper voltage level applied for this set-up? | Please use the proper level of power input for the device. (AC 100~220V, 50/60Hz) |
| | Is the switch off at back of the device? | Turn on the power switch. |
| There is no ionization. | Does the installed environment have too high/low level of humidity or temperature? | Please install the device upon the proper working specification. |
| The ionizing performance has been decreased. | Can't possibly ground the device? | Please refer to 'Installation & Connection' for (proper) grounding the device. |
| | Any damages or cut on the cables? | You need to replace the cables if it gets cut or damaged. |

7 Dimensions

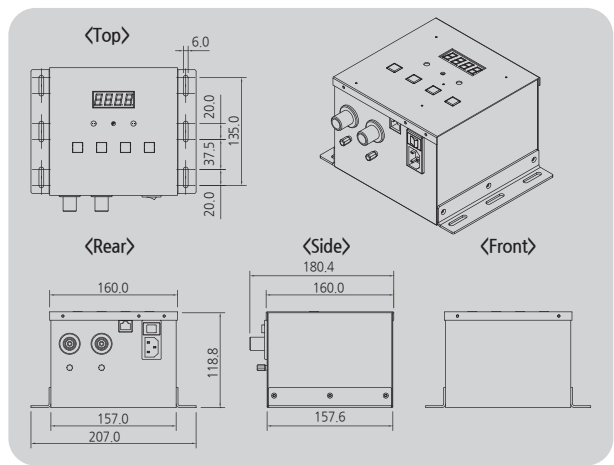

8 Specification

▶ SBP-07A2

| Parameter | Description / Value | Remarks | |
|--------------------------|--|---|--|
| Input Power | AC 100~240V, 50/60Hz | | |
| Power Consumption | 33W | | |
| Output Power | AC 4kV~7.5kV(±7%) 55Hz(±5Hz), Less than 5mA Ion Balance(Offset) : DC -150V ~+550V | 100V Digital step adj. Analog volume Control | |
| Ionizer number connector | 2 Port | | |
| Display | FND | Output Voltage | |
| | LED | RUN(Green), Alarm(Red) | |
| Alarm | A-1 | If more than 5mA of AC output current | When the alarm is appeared, power off the output |
| | A-2 | If more than 125% of AC output voltage | |
| | A-3 | If less than 75% of AC output voltage | |
| | A-4 | If output short-circuit occurs. | |
| Button S/W | RUN | Operation start after stoppage | |
| | STOP | Output power off(stop) | |
| | UP/DOWN | Output voltage control (press the button for 2 seconds) | 0.1kV Adj. |
| Operation Circumstance | Use temperature / Humidity Preservation temperature / humidity | 0~50°C / 10~90% RH -20~70°C / 10~95% RH | No condensation / No freezing |
| | Interface | Remote On Remote Off Run State Alarm(Stop) State | |
| Weight | 5kg | | |
| Dimension [mm] | 160(W) X 118.8(H) X 207(D) | | |
| Main body material | EGI | | |
| Mounting Method | Desktop / Wall | | |
| Warranty | 1 year | | |

* The appearance and specification of the product may be changed without prior notice for the improvement of the product.

SUNJE Electrostatics

www.sunstat.com

Head Office & Factory (Busan)
8, Cheongwang-gil, Ilgwang-Myeon, Gijang-gun, Busan, Korea
T) +82-51-720-7500 F) +82-51-720-7501

Sunje Japan Co., Ltd.
3-11-16-321 Higashimikuni, Yodogawa-ku, Osaka, Japan
T) +81-6-4866-5202 F) +81-6-6399-9290

Central Sales Office (Hwaseong)
3F, Ilshin B/D, 4, Namnyeoul 2-gil, Hwaseong-si, Gyeonggi-do, Korea
T) +82-31-203-9034 F) +82-31-202-9034

Sunje (SHANGHAI) Trading Co., Ltd.
Room 312, Jiurun Business Building 3rd Floor, No. 298, Yindu Road, Xuhui District, Shanghai, China 200000
T) +86-21-5433-9761 F) +86-21-5433-9762

Southern Sales Office (Chilgok)
35-2, Seojungni 3-gil, Seokjeok-eup, Chilgok-gun, Gyeongsangbuk-do, Korea
T) +82-54-476-9033 F) +82-54-476-9034

Sunje Technology Co., Ltd.
2F, No.6, Lane.102, Sinhe Rd, Sinfong Township, Hsinchu County, Taiwan 30472
T) +886-3-568-7891 F) +886-3-568-7950

Customer Center +82-70-7714-9033
Sales Contact +82-31-203-9034