



It is recommended that only persons who have sufficient knowledge and experience such as system designers and responsible persons deal with this product after carefully reading the product manual.

1 The matters of safety

WARNING

- \* If the equipment is used in a manner not specified by the manufacturer, the protection provided by the equipment may be impaired.
- \* Do not let the water touch the product. It may cause electric shock or fire due to malfunction.
- \* When you check or maintain the product, make it sure you turn off the power. It may cause electric shock or fire due to malfunction.
- \* The item should be fixed to the target tightly. Electric discharging or breakage might happen.
- \* Do not use the product at the place where dangerous material such as inflammable or ignitable material exists. This product is not the product of anti-explosive type.
- \* This device is made only for industrial uses. You need to ground the device beforehand. Otherwise, there are in case of malfunction, electric shock, or fire damage.

CAUTION

- \* Do not disconnect the controller cable with power applied. There is a possibility of electric shock or malfunction.
- \* Connect wires referring to the product manual. Wrong connection can cause failures.
- \* For your proper cable connection, take a look at the manual 'Installation & Connection' for references. Any disordered connection is detected, the malfunction might arise.
- \* All cables should be connected all the time. Please careful of cable disconnections. If power or communication cables got damaged, replace them immediately. Malfunction and fire danger may happen.
- \* Do not install the device where the vibration can be detected. Any minor impact or vibration on the device, the malfunction or danger of accident might happen.
- \* Do not use the item off the range of usage(Electrostatic elimination). Malfunction or danger of accident may occur.

2 Check the package contents

Product compositions (Standard)

The package includes the following products composition.

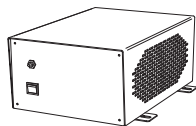

Power Controller SBP-08A3 / 1ea

- \* Connector Cap SCC-BM-001 2ea
- \* H/V connector SHC-BM-001 1~2ea
- \* H/V Cable Fixing pin SHF-BM-001 1~2ea
- \* AC Plug SAP-BM-001 1ea
- \* Ground Cable SGC-MT-4-001 1m /06-04[mm] / 1ea
- \* Power Cable SPC-BM-1-001 AC 100V, 50/60Hz, 1.8m / 1ea
- or
- \* Power Cable SPC-BM-2-001 AC 220V, 50/60Hz, 1.8m / 1ea

※ This product is not the product of anti-explosive type.

Product compositions (Option)

In the option package with shield bracket, the below item is contained.

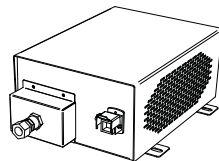

Power Controller (Option) SBP-08A3 / 1ea

- \* Connector Cap SCC-BM-001 2ea
- \* AC Plug SAP-BM-001 1ea
- \* Ground Cable SGC-MT-4-001 1m /06-04[mm] / 1ea
- \* Power Cable SPC-BM-1-001 AC 100V, 50/60Hz, 1.8m / 1ea
- or
- \* Power Cable SPC-BM-2-001 AC 220V, 50/60Hz, 1.8m / 1ea

※ This package is the option product and 1:1 type. This product is not the product of anti-explosive type.

3 Nomenclatures of parts

SBP-08A3

Front

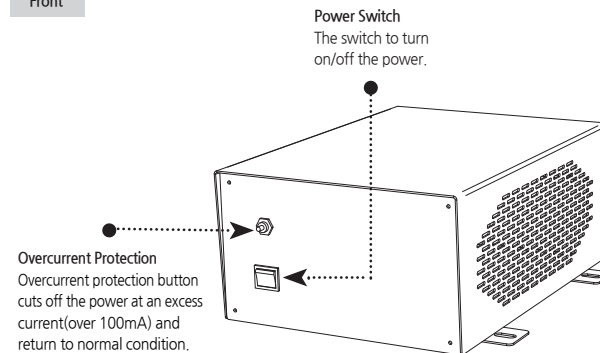

Sequence of operation in protection function

1. Alarm occurs.
2. Protection switch operates. / SBP-08A3 is turned off.
3. Alarm cause removal
4. After about 1 minute, SBP-08A3 returns to operation preparation condition.
5. Press protection switch.
6. SBP-08A3 operates again.

Rear

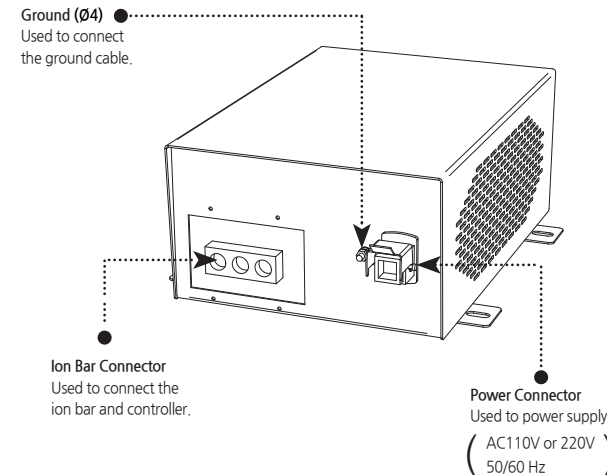

4 Installation and connection

WARNING

- \* During installation, please try to avoid the area where the product might get (electrical) stress. There might be chances for cable breakage, electric shock, or fire explosion.
- \* Please be sure to use a ground cable for safety purposes and we suggest you to use ground resistance smaller than 100Ω.

Connectable products

The SBP-08A3(i.e.Power Controller) can be connected to the(multiple) products as below.

Ion Balance	Type	Model	Construction	Standard Operating Voltage
Non-Adjustable	Ion Bar	SIB-ex	Capacity Coupled	AC 8kV ±7%(Max.)
		SIBM		

- \* Try not to assemble with the product that is not properly specified to install. It will be causes of malfunction or operation disorder.
- \* Please contact us if you want to use every different model (only with models in the table) in the connection. Connecting the product based on your own discretion, it can cause product failure and malfunction.

CAUTION

► How to select input voltage of "AC Power Plug"

First, you need to choose desired input voltage. Then, assemble accordingly. Please refer to the following picture. If the installation is improperly done compared to the guide we provided, we cannot guarantee any product disorders via your false installation.

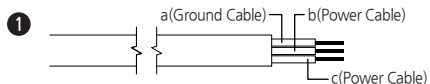

- Strip insulated (a,b,c) wires off from the edge of power cable about 10mm as a picture below.

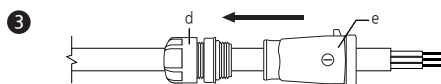

- Place a cable, then connect a seperated cable grand(d) and AC power plug cover(e) in the correct orders.

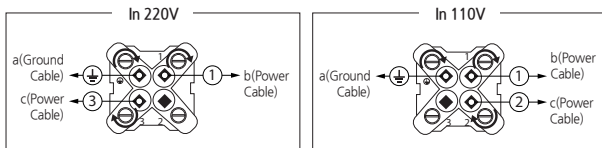
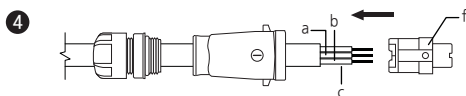

- Place the insulated(a,b,c) wires to AC power plug jack(f) as a following picture, then tighten it with a screwdriver.

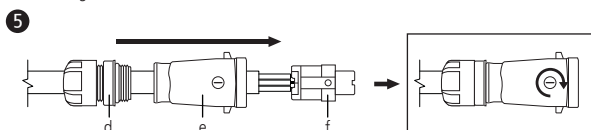

- Push AC power plug cover(e) and cable grand(d) towards the AC power plug jack direction. Align the hole of AC power plug jack on the AC power plug cover, then tighten it with a screwdriver.

► H/V Cable Connection (Standard)

The SBP-08A3(i.e.Power Controller) can be connected to the(multiple) products as below.

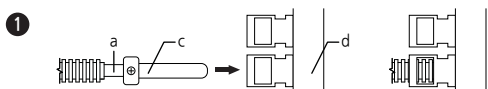

- Insert the High-Voltage Pin(c) in Controller(d) as the black part of H/V Cable should not be seen.

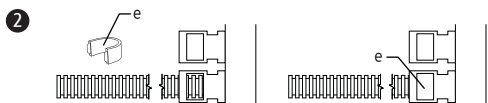

- Push in the Alignment Pin of High-Tension Wire(e) until "click" sound occurs.

► H/V Cable Connection (Option)

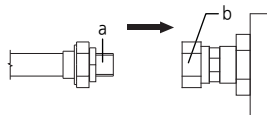

- Push flexible shield(a) into the shield bracket(b) and tighten the bracket using tools.

5 Problem solving

► Checklist before called

Problem	Identifying Problem	Solution
The product does not work.	Is your power cable still plugged in?	Please re-plug the power cable and then turn the device on again.
	Was the proper voltage level applied for this set-up?	Please use the proper level of power input for the device. (AC 110 or 220V, 50/60Hz)
	Is the swith off at back of the device?	Turn on the power switch.
There is no ionization.	Does the installed environment have too high/low level of humidity or temperature?	Please install the device upon the proper working specification.
The ionizing performance has been decreased.	Can't possibly ground the device?	Please refer to 'Installation & Connection' for(proper) grounding the device.
	Any damages or cut on the cables?	You need to replace the cables if it gets cut or damaged.

6 Dimensions

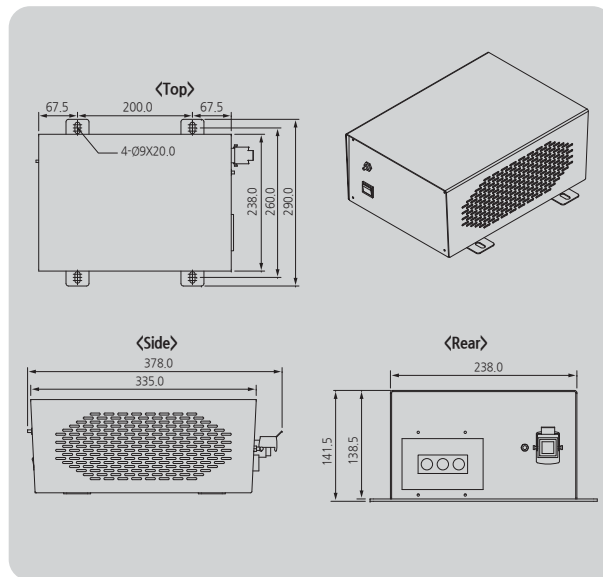

7 Specification

► SBP-08A3

Parameter	Description / Value	Remarks
Input Power	AC 110V or AC 220V, 50/60Hz	
	110V Max 24.2VA(220mA)	
Power Consumption	220V Max 24.2VA(110mA)	
Output Port	3 Ports	
Output Voltage	AC 8kV ±7% (Max.)	
Operating Temperature	0°C ~ +50°C(32°F ~ 122°F)	
Weight	8.1kg	
Cover Material	EGI	
Installation Location	To be installed at a non hazardous place	
Dimensions	See the accompanying drawing paper	
Protection	Circuit breaker for equipment thermal	
Mounting Method	Desk top or wall mount	
Size	238 x 335 x 141.5mm	
Warranty	1 year	

※ The appearance and specification of the product may be changed without prior notice for the improvement of the product.

SUNJE Electrostatics

www.sunstat.com

- Head Office & Factory (Busan)**  
8, Cheonggwang-gil, Ilgwang-Myeon, Gijang-Gun, Busan, Korea  
T) +82-51-720-7500 F) +82-51-720-7501
  - Sunje Japan Co., Ltd.**  
3-1-16-321 Higashimikuni, Yodogawa-ku, Osaka, Japan  
T) +81-6-4866-5202 F) +81-6-6399-9290
  - Central Sales Office (Hwaseong)**  
3F, Ilshin B/D, 4, Namnyeoul 2-gil, Hwaseong-si, Gyeonggi-do, Korea  
T) +82-31-203-9034 F) +82-31-202-9034
  - Sunje (SHANGHAI) Trading Co., Ltd.**  
Room 312, Jilun Business Building 3rd Floor No. 298, Yindu Road, Xuhui District, Shanghai, China 200000  
T) +86-21-5433-9761 F) +86-21-5433-9762
  - Southern Sales Office (Chilgok)**  
35-2, Seojungni 3-gil, Seokjeok-eup, Chilgok-gun, Gyeongsangbuk-do, Korea  
T) +82-54-476-9033 F) +82-54-476-9034
  - Sunje Technology Co., Ltd.**  
2F, No.6, Lane.102, Sinhe Rd, Sinfong Township, Hsinchu County, Taiwan 30472  
T) +886-3-568-7891 F) +886-3-568-7950
- Customer Center** +82-70-7714-9033  
**Sales Contact** +82-31-203-9034